

DEMOLITION NOTES:

- ANY DAMAGE RESULTING FROM THE WORKS MUST BE IMMEDIATELY RECTIFIED BY THE CONTRACTOR AT THEIR OWN EXPENSE.
- DEMOLITION SHALL BE CARRIED OUT SO AS TO CAUSE NO DISTURBANCE TO SURROUNDING STRUCTURES. CARE TO BE TAKEN BELOW SLAB LEVEL.
- LOCATE AND PREVENT ANY DAMAGE TO EXISTING SERVICES. IMMEDIATELY RECTIFY ANY DAMAGE OR INTERFERENCE TO THESE SERVICES AND PROVIDE TEMPORARY SERVICES WHILE REPAIRS ARE BEING CARRIED OUT.
- ALL NECESSARY PRECAUTIONS SHALL BE TAKEN TO PREVENT DAMAGE TO ALL ADJACENT WORK. SHOULD ANY DAMAGE OCCUR, THE CONTRACTOR SHALL MAKE GOOD TO THE STANDARD OF THE ORIGINAL.
- IF AND WHEN OPENING UP ANY WORK, ANY CONDITIONS ARE FOUND TO BE UNSOUND OR UNSAFE THE CONTRACTOR SHALL STOP WORK AND NOTIFY THE ARCHITECT FOR HIS INSTRUCTIONS.
- PEG AND LABEL ALL CUT / REDUNDANT SERVICES FOR LATER IDENTIFICATION.
- PROVIDE AS CONSTRUCTED DRAWINGS INDICATING LOCATION OF ALL SERVICES.
- THE CONTRACTOR SHALL REMOVE FROM SITE ALL DEBRIS AND ASSOCIATED WASTE.
- ONCE DEMOLITION'S ARE COMPLETED AND PHOTOGRAPHIC RECORDS TAKEN THE CONTRACTOR SHALL PREPARE AREAS FOR NEW WORK.
- CONTRACTOR TO REFER TO SPECIFICATION FOR ITEMS TO BE SALVAGED.

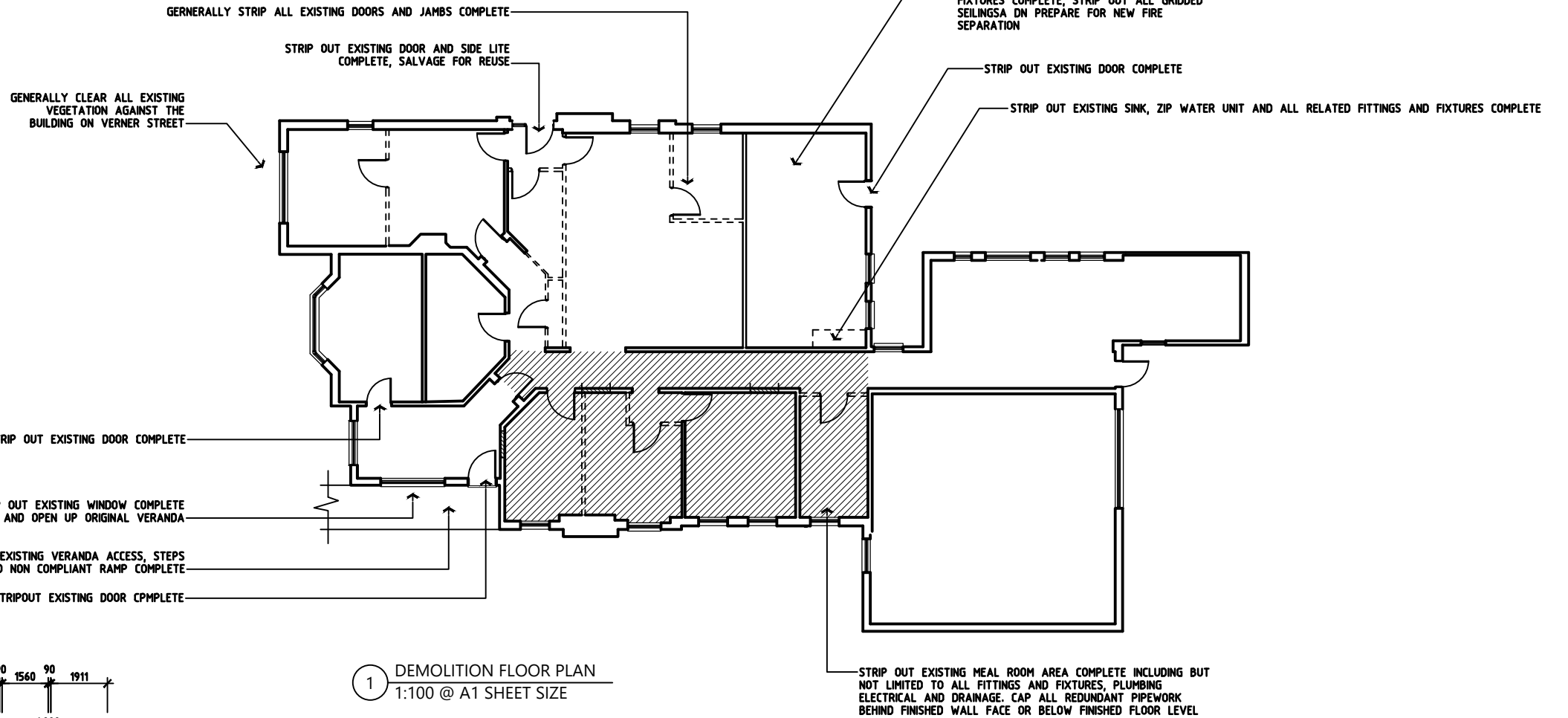

1 DEMOLITION FLOOR PLAN
1:100 @ A1 SHEET SIZE

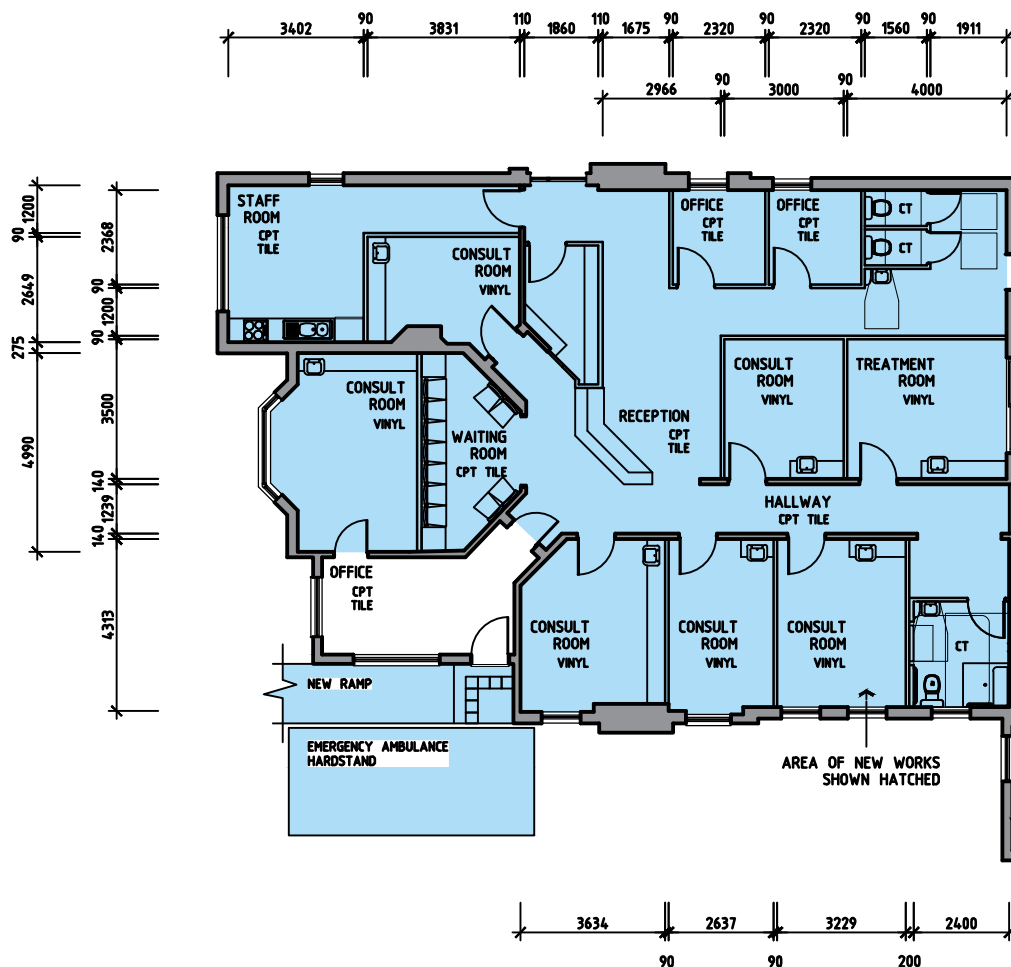

2 PROPOSED FLOOR PLAN
1:100 @ A1 SHEET SIZE

COMPLIANCE NOTES:

- ALL FLOOR LEVELS & GROUND LEVELS ARE ASSUMED & ARE TO BE CONFIRMED ONSITE, PRIOR TO COMMENCING ANY WORKS.
- IT IS THE RESPONSIBILITY OF THE CONTRACTOR AND SUB-CONTRACTORS TO MAKE THEMSELVES FULLY AWARE OF CONDITIONS WHICH WILL AFFECT THE EXECUTION OF THE WORKS.
- THE CONTRACTOR IS TO ENSURE COMPLETE COMPLIANCE WITH ALL RELEVANT NCC CODES, AUSTRALIAN STANDARDS AND LOCAL REGULATIONS AND BY-LAWS AS REQUIRED.
- ALL MATERIALS & WORKMANSHIP ARE TO BE IN STRICT ACCORDANCE WITH THE MANUFACTURER'S CURRENT PRINTED INSTRUCTIONS.
- ALL MATERIALS & WORKMANSHIP ARE TO BE OF BEST QUALITY UNDERTAKEN BY FULLY QUALIFIED TRADESMEN. ALL MATERIALS TO BE SUPPLIED NEW. ALL DAMAGED MATERIALS TO BE REJECTED AND REPLACED WITH NEW.
- IF ALTERNATIVE MATERIAL OR PRODUCT IS PROPOSED TO THAT SPECIFIED, THE BUILDER MUST PROVIDE EVIDENCE SHOWING COMPLIANCE WITH THE NCC AND ALL RELEVANT STANDARDS RELATING TO THE APPLICATION OF THE PROPOSED MATERIAL. FURTHER THE ARCHITECT ACCEPTS NO LIABILITY OR INDEMNITY FOR THE SUBSTITUTION OF A MATERIAL CONTRARY TO THAT SPECIFIED BY THE ARCHITECT WITHOUT THE PROVISION OF WRITTEN DOCUMENTATION SHOWING COMPLIANCE WITH THE BCA AND AUSTRALIAN STANDARDS AND THE EXPRESS WRITTEN APPROVAL OF THE ARCHITECT.
- THE CONTRACTOR IS TO NOTIFY THE PROJECT MANAGER OF ANY ERRORS OR OMISSIONS IN THE DOCUMENTATION PRIOR TO COMMENCING WORK. THE PROJECT MANAGER TO CONTACT THE APPROPRIATE CONSULTANT FOR ADVICE PRIOR TO COMMENCING THE WORKS.
- COMMENCEMENT OF THE WORKS BY THE CONTRACTOR CONSTITUTES A FULL UNDERSTANDING OF THE PROJECT & ACCEPTANCE OF ALL SITE CONDITIONS & THE SUPPLIED DOCUMENTATION.
- TIM LEE ARCHITECTS ACCEPTS NO RESPONSIBILITY OR INDEMNITY FOR CONDITIONS, LATENT OR OTHERWISE, ARISING WITHOUT NOTIFICATION PRIOR TO COMMENCING THE WORKS.
- ALL WORK TO BE CARRIED OUT BY COMPETENT, SKILLED & QUALIFIED TRADESPEOPLE HOLDING CURRENT CERTIFICATION WITH THE REQUIRED AUTHORITY.
- PROVIDE ALL MATERIALS, LABOUR & EQUIPMENT NECESSARY TO COMPLETE THE WORK AS PER THE DRAWING SET & ASSOCIATED DOCUMENTATION.
- GRADE FINISHED GROUND LINE TO GIVE FALLS AWAY FROM BUILDINGS.
- TERMITE CONTROL TO ALL AREAS AS REQUIRED BY AS 3660.1 & 3660.2.
- INSTALL HARD WIRED SMOKE ALARMS TO AS 3786.
- ALL WALLS TO BE WRAPPED IN ENVIROSEAL COMMERCIAL WALL WRAP. ALL JOINTS TO BE LAPPED MIN. 300mm AND TAPED. FIX TO MANUFACTURER'S CURRENT PRINTED INSTRUCTIONS.
- RANGE HOODS EXHAUST SYSTEMS TO HAVE A MINIMUM FLOW RATE OF KITCHENS 5 LS/m² & CHANGEROOMS 5 LS/m² TO AS 4674 & AS 1668.2.
- EXHAUSTS FROM BATHROOMS & LAUNDRY MUST BE DISCHARGED DIRECTLY OR VIA A SHAFT OR DUCT TO OUTSIDE AIR. INSTALL TO MANUFACTURER'S CURRENT PRINTED INSTRUCTIONS. REFER TO MECHANICAL DETAILS.
- MECHANICAL VENTILATION & LIGHTING TO MEET NCC PART F4.
- ONCE WINDOWS ARE INSTALLED, CONTRACTOR TO SEAL WINDOW PERIMETERS WITH EXPANDING FOAM FILLER FIRE RETARDANT TO GIVE FULLY AIR-TIGHT SEAL AGAINST FRAME. INSTALL TO MANUFACTURER'S CURRENT PRINTED INSTRUCTIONS.
- SITE PREPARATION SHALL BE CARRIED OUT IN ACCORDANCE WITH ENGINEER'S DETAILS.
- A JAS-ANZ ACCREDITED 3RD PARTY PROCESSOR CERTIFICATE (ACRS OR EQUIVALENT) MUST BE SUPPLIED WITH ALL STEEL REINFORCEMENT AT PROCUREMENT, BEFORE ANY CONCRETE IS PLACED TO GUARANTEE CONFORMANCE OF THE REINFORCEMENT TO AS/NZS 4671.
- LIFT OFF HINGES TO ALL WC COMPARTMENT DOORS WHERE OPENING INWARDS.
- CLADDING TO BE INSTALLED IN ACCORDANCE WITH MANUFACTURER'S CURRENT PRINTED INSTRUCTIONS. INSTALL OVER ENVIROSEAL COMMERCIAL WALL WRAP. LAP & TAPE ALL JOINTS & FRAME PENETRATIONS TO ENSURE AN AIRTIGHT BUILDING SEAL.



DRAWING AMENDMENTS		PROJECT TITLE		DRAWING TITLE		DRAWING NUMBER		DRAWING DATE		DRAWING REVISION	
AMENDMENT NO. A		NEW MEDICAL CENTRE		FLOOR PLAN		MAR 2024		-		TL	
ISSUED FOR DEVELOPMENT APPLICATION		CLIENT		LOT AND OFFICED PLAN NO.		S.A.S.		JOB NUMBER		AMENDMENT NO.	
DATE 05/24		CARTWRIGHT VERNER PTY LTD		LOT 1 & 3 DP 1060354		AT SHEET		0224 - 1651		A	
PROJECT ADDRESS		DRAWING SCALE		SHEET NUMBER		SHEET TOTAL		DRAWING IDENTIFICATION NUMBER		DATE	
VERNER STREET		1:100		1 OF 1		1 OF 1		0224 - 1651 - 03		-	
GOULBURN NSW 2580		PROJECT NUMBER		PROJECT NAME		PROJECT ADDRESS		PROJECT NUMBER		PROJECT NAME	
-		-		-		-		-		-	